

PLATE & PATINA - STUDIO INFO PACKET

Studio Spaces & Rates

Kitchen Studio: \$1200/day (still), \$1500/day (video)

730 sqft of private shooting space, plus add'l storage space
Capacity: 1 - 13 people

Full shooting kitchen & open shooting space with gas fireplace
12' x 12' walled room with barn door and closet
Private bathroom with shower
13' ceilings, exterior access and direct access to prop house
4 standard and 1 handicap parking lot spots

Little Studio: \$700/day

272 sqft of private shooting space,
plus add'l storage space
Capacity: 1 - 7 people
13' ceilings, direct access to prop house

**Both Studios in tandem:
\$1600/day (still), \$1900/day (video)**

Additional non-metered street parking is available on Naomi Street.
List of grip and kitchen equipment available upon request.

Studio rental days are 10 hours, from 8:00am to 6:00pm, unless otherwise approved by P&P.

- **Weekends (if available):** 1.25x day rate (i.e. Kitchen Studio: \$1,500/day, Little Studio: \$875/day)
- **Holidays (if available):** 1.5x day rate (i.e. Kitchen Studio: \$1,800/day, Little Studio: \$1050/day)

Please inquire for cookbook and test shoot rates.

Events are not permitted.

Additional Fees

- **Utility Recovery Fee: \$50+/day, applies to all shoots in Kitchen Studio.** Additional fees will apply if excessive a/c, heat, hot lights, and/or specialty equipment/appliances are used, or if there is an increase in local market utility prices.
- **Excessive Trash Pick Up Fee:** \$150 fee per pick up
- **Cleaning Fee: \$250+.** Cleaning fees are not included in the studio rental rate - please clean and restore studio to original state by the end of the final shoot day to avoid these charges.
- **Exclusive use of the Courtyard:** \$400/day (must be added in order to shoot outside)
- **Fireplace usage:** \$150/day

Overtime

We offer a 15 minute grace period after the last hour ends. After 15 minutes, another hour is charged.

- First two hours overtime: 1.5x hourly rate each
- Additional hours overtime: 2x hourly rate each

Locked Studio Rate/Non-Consecutive Shoot Days

All equipment, props, surfaces, and any personal property must be removed from the studio at the end of the day if the studio is not rented the following day.

If you'd like to keep all equipment and supplies in the studio on non-shoot days, a Locked Studio Fee may be required on a case by case basis. **There will be no access to the Studio on locked studio days.**

Studio Holds and Confirmations

Studio dates can be held up to 6 months in advance without a deposit. In order to confirm, submit the signed Studio Rental Agreement and Credit Card Authorization Form. **The total studio rental amount will be charged to the card as a deposit upon confirmation. All studio holds must be confirmed a minimum of 5 business days prior to the shoot.**

First Hold and Second Hold

If someone wants to place a hold on a day that is *already held* for someone else, they can be waitlisted as a **Second Hold**. The **First Hold** will be notified that someone else is interested in that day. We will notify the **Second Hold** if the **First Hold** confirms, and the day is no longer available.

If a **Second Hold** is ready to confirm the day with a deposit, the **Second Hold** must provide Plate & Patina with valid credit card information. Plate & Patina will contact the **First Hold** and give them the option to either release the day, or provide a deposit within 24 hours.

If the **First Hold** provides the deposit, the **Second Hold** will be informed that the day is no longer available and the card information for the **Second Hold** will be destroyed, or, if requested, kept on file for future use.

If the **First Hold** releases the day, or does not provide a deposit within 24 hours, the **Second Hold** will be automatically confirmed, and the deposit will be charged to their card.

Cancellations & Refunds

- **Holds:** no penalty
- **Confirmed shoots, more than 5 business days in advance:** 50% refund per cancelled day
- **Confirmed shoots, less than 5 business days in advance:** no refund

Rescheduling after confirmation is handled on a case by case basis.

If Plate & Patina cancels one or all of a Client's confirmed Rental Days for a reason within its control, the Client will be given either rescheduling priority or a full refund.

Certificate of Insurance

\$1M general liability COI is required and must be submitted at least 2 business days prior to the shoot.

Crew & Talent

A call sheet/contact list must be submitted to P&P at least 2 business days prior to the shoot. It must include the following info of all crew, clients, and talent that will be on P&P property:

- Name
- Phone Number
- Role
- Email Address

No one is allowed in the studio that is not on the contact sheet. Separate contact sheets may be submitted for separate days. Minors and animals must have a dedicated supervisor/wrangler at all times. No animals are allowed on any portion of Plate & Patina's property without prior approval.

Props and Surfaces

A la carte: 30% off sticker price, may be used for duration of shoot

Unlimited Props: \$800/day. Includes 4 surfaces per day.
Addt'l surfaces may be added per day a la carte at 30% off.

Props and surfaces can be held up to 2 business days prior to the shoot.
All prop and surface charges are subject to tax.

Props and surfaces must be confirmed with a P&P employee before they enter the studio from the warehouse. Items not checked in will be charged at the full listed rental price and will not be subject to any discounts or packages.

P&P Studio Rules

- Studio space must be cleaned and fully vacated by the end of the last shoot day.
- All load in and load out must take place between 8am-6pm on the shoot day. No drop-off or pick-up of equipment before or after completion of a shoot. Items left behind may incur a storage fee. P&P will reach out within 2 business days if items are left behind. Items not retrieved after 5 business days will be considered abandoned.
- No hazardous, illegal, or negligent practices, activities or substances may be used during any part of the rental period.
- No smoking/vaping inside any building or within 30 feet of any entrance to any building on Plate & Patina's property.
- Props and surfaces are not food safe and may not be used for catering/serving purposes
- P&P employees may enter the studio during the shoot at any time.
- Studio Fees are paid for upon confirmation; Utility Recovery Fee, additional fees, overtime fees, and Props & Surfaces are paid for after the shoot ends.

STUDIO BOOKING & DUE DATE TIMELINE

6 MONTHS PRIOR TO SHOOT DATE

Shoot date becomes available to place on hold

You may confirm your shoot dates at any time, but Studio Rental Fees will be charged in full upon confirmation, and 50% of those fees will be non-refundable.

5 BUSINESS DAYS PRIOR TO SHOOT DATE

Studio Contract due
Credit Card Authorization Form due
Shoot dates must be fully confirmed
Studio Rental Fees will be charged in full
(if they haven't been already)
and are now 100% non-refundable
Specialty equipment must be approved by P&P

2 BUSINESS DAYS PRIOR TO SHOOT DATE

Certificate of Insurance due
Contact Sheet due
Props & Surfaces may be pulled aside to hold

THE DAY BEFORE

Must confirm following days' props as 'A La Carte' or 'Unlimited' to P&P staff

PLATE & PATINA - PROPERTY MAP

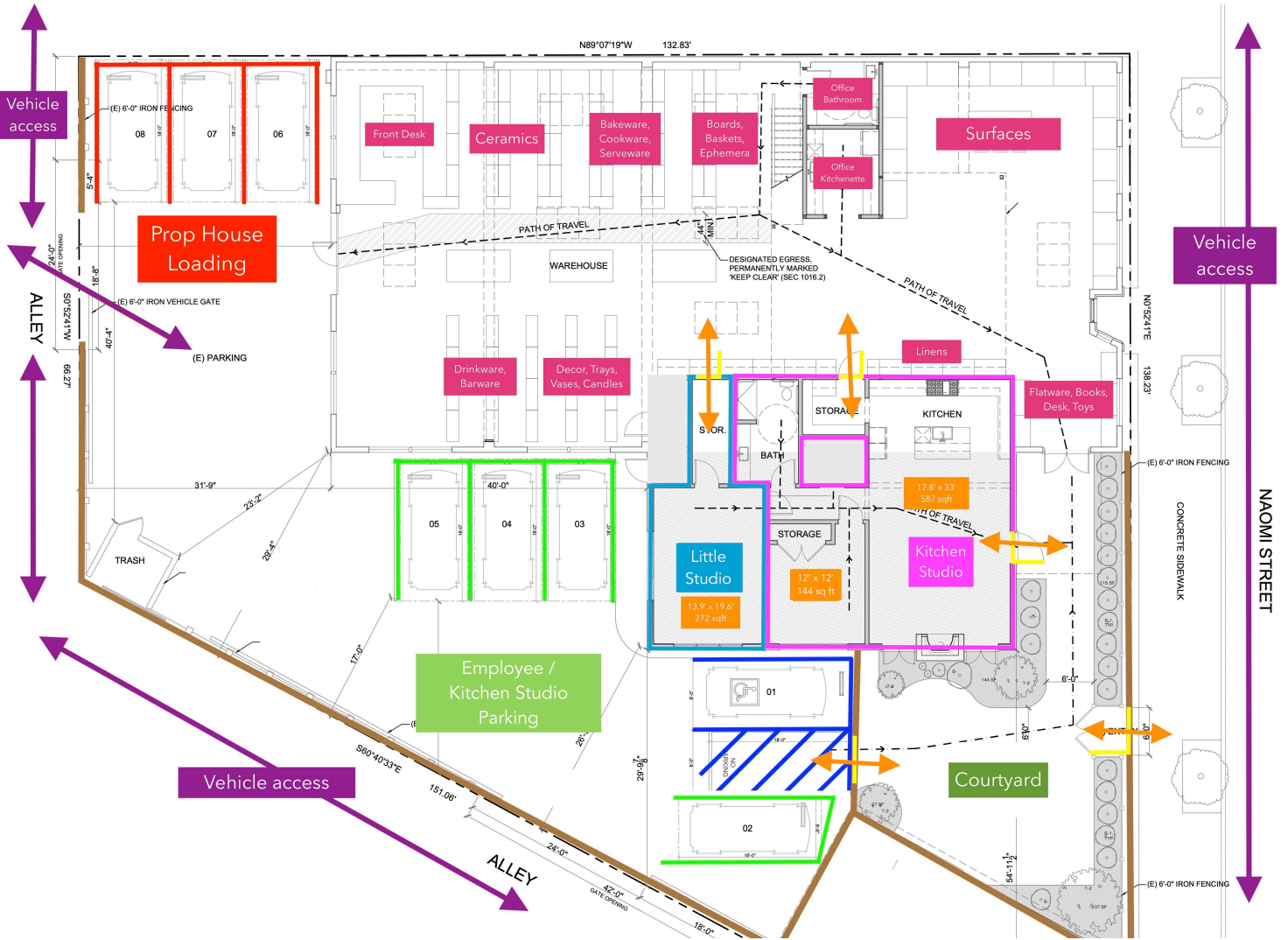

PLATE & PATINA - STUDIO FLOOR PLAN

